

Интегрированные серводвигатели серии R88

КАРТА ЗАКАЗА

Заполненный опросный лист необходимо направить по электронной почте orm@nt-rt.ru

Архангельск (8182)63-90-72
Астана +7(7172)727-132
Белгород (4722)40-23-64
Брянск (4832)59-03-52
Владивосток (423)249-28-31
Волгоград (844)278-03-48
Вологда (8172)26-41-59
Воронеж (473)204-51-73
Екатеринбург (343)384-55-89
Иваново (4932)77-34-06
Ижевск (3412)26-03-58
Казань (843)206-01-48

Калининград (4012)72-03-81
Калуга (4842)92-23-67
Кемерово (3842)65-04-62
Киров (8332)68-02-04
Краснодар (861)203-40-90
Красноярск (391)204-63-61
Курск (4712)77-13-04
Липецк (4742)52-20-81
Магнитогорск (3519)55-03-13
Москва (495)268-04-70
Мурманск (8152)59-64-93
Набережные Челны (8552)20-53-41

Нижний Новгород (831)429-08-12
Новокузнецк (3843)20-46-81
Новосибирск (383)227-86-73
Орел (4862)44-53-42
Оренбург (3532)37-68-04
Пенза (8412)22-31-16
Пермь (342)205-81-47
Ростов-на-Дону (863)308-18-15
Рязань (4912)46-61-64
Самара (846)206-03-16
Санкт-Петербург (812)309-46-40
Саратов (845)249-38-78

Смоленск (4812)29-41-54
Сочи (862)225-72-31
Ставрополь (8652)20-65-13
Тверь (4822)63-31-35
Томск (3822)98-41-53
Тула (4872)74-02-29
Тюмень (3452)66-21-18
Ульяновск (8422)24-23-59
Уфа (347)229-48-12
Челябинск (351)202-03-61
Череповец (8202)49-02-64
Ярославль (4852)69-52-93

Ordering information

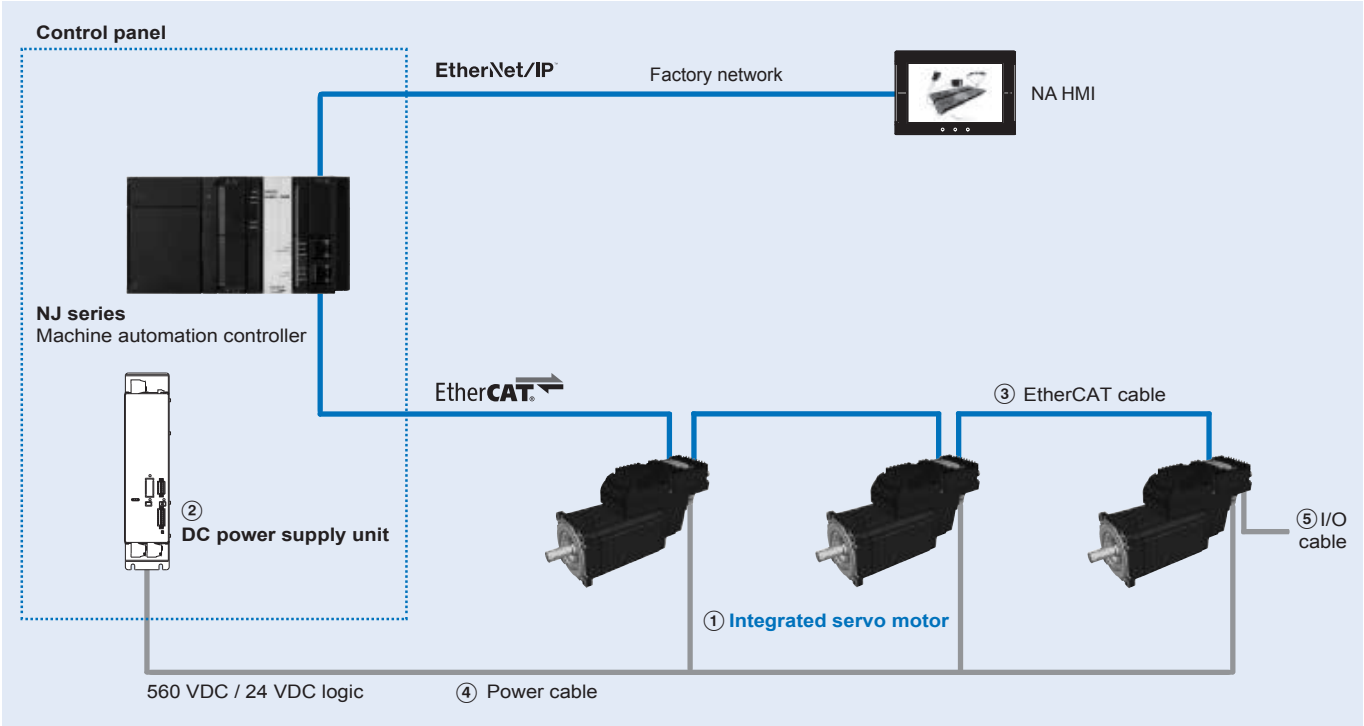

Integrated servo motor

Symbol	Specifications				Model		
	Voltage	Encoder and design		Rated torque	Capacity		
①	560 VDC	Incremental encoder	Without brake	Straight shaft with key	2.55 Nm	880 W	R88E-AECT0230D-S2
					3.2 Nm	1000 W	R88E-AECT0330D-S2
					4.3 Nm	1350 W	R88E-AECT0430D-S2
					5.0 Nm	1570 W	R88E-AECT0530D-S2
					11.7 Nm	3670 W	R88E-AECT1130D-S2
			25 Nm	7850 W	R88E-AECT2530D-S2		
			With brake	2.55 Nm	880 W	R88E-AECT0230D-BS2	
				3.2 Nm	1000 W	R88E-AECT0330D-BS2	
				4.3 Nm	1350 W	R88E-AECT0430D-BS2	
				5.0 Nm	1570 W	R88E-AECT0530D-BS2	
		11.7 Nm		3670 W	R88E-AECT1130D-BS2		
		Multiturn absolute encoder	Without brake		2.55 Nm	880 W	R88E-AECT0230E-S2
					3.2 Nm	1000 W	R88E-AECT0330E-S2
					4.3 Nm	1350 W	R88E-AECT0430E-S2
					5.0 Nm	1570 W	R88E-AECT0530E-S2
					11.7 Nm	3670 W	R88E-AECT1130E-S2
			25 Nm	7850 W	R88E-AECT2530E-S2		
			With brake	2.55 Nm	880 W	R88E-AECT0230E-BS2	
				3.2 Nm	1000 W	R88E-AECT0330E-BS2	
				4.3 Nm	1350 W	R88E-AECT0430E-BS2	
5.0 Nm	1570 W			R88E-AECT0530E-BS2			
11.7 Nm	3670 W	R88E-AECT1130E-BS2					
25 Nm	7850 W	R88E-AECT2530E-BS2					

DC power supply unit

Symbol	Specifications				Model
	Voltage input	Output current	Output power	Regeneration circuit	
②	400 V 3-phase	20 A	11.3 kW	Integrated	R88S-EAD20R
		40 A	22.5 kW		R88S-EAD40R

Cables

Symbol	Specifications	Model	Appearance		
③	EtherCAT cables EtherCAT RJ45 to M12 cable (M12 straight)	0.3 m	XS5W-T421-AMC-K		
		0.5 m	XS5W-T421-BMC-K		
		1 m	XS5W-T421-CMC-K		
		2 m	XS5W-T421-DMC-K		
		3 m	XS5W-T421-EMC-K		
		5 m	XS5W-T421-GMC-K		
		10 m	XS5W-T421-JMC-K		
			15 m	XS5W-T421-KMC-K	
	EtherCAT RJ45 to M12 cable (M12 L right angle)	0.3 m	XS5W-T422-AMC-K		
		0.5 m	XS5W-T422-BMC-K		
		1 m	XS5W-T422-CMC-K		
		2 m	XS5W-T422-DMC-K		
		3 m	XS5W-T422-EMC-K		
		5 m	XS5W-T422-GMC-K		
		10 m	XS5W-T422-JMC-K		
			15 m	XS5W-T422-KMC-K	
	EtherCAT M12 to M12 cable (M12 straight)	0.5 m	XS5W-T421-BM2-K		
		1 m	XS5W-T421-CM2-K		
		2 m	XS5W-T421-DM2-K		
		3 m	XS5W-T421-EM2-K		
5 m		XS5W-T421-GM2-K			
10 m		XS5W-T421-JM2-K			
15 m		XS5W-T421-KM2-K			
EtherCAT M12 to M12 cable (M12 L right angle)	0.5 m	XS5W-T422-BM2-K			
	1 m	XS5W-T422-CM2-K			
	2 m	XS5W-T422-DM2-K			
	3 m	XS5W-T422-EM2-K			
	5 m	XS5W-T422-GM2-K			
	10 m	XS5W-T422-JM2-K			
	15 m	XS5W-T422-KM2-K			
④	Power cables for Integrated servo motor with straight connector	1.5 m	R88A-CDEA001-5-E		
		3 m	R88A-CDEA003-E		
		5 m	R88A-CDEA005-E		
		10 m	R88A-CDEA010-E		
		15 m	R88A-CDEA015-E		
		20 m	R88A-CDEA020-E		
⑤	I/O cables with straight connector	1 m	R88A-CPEA001S-E		
		2 m	R88A-CPEA002S-E		
		5 m	R88A-CPEA005S-E		
-	Serial port cables	For Integrated servo motor with straight connector	2 m	R88A-CCEA002P2-E	
		For DC power supply unit with straight connector	2 m	R88A-CCSE002P2-E	

Accessories

Specifications	Model		
Connectors for making power cables	M23 straight connector	R88A-CNEA01P-E	
	M23 right angle 90° connector	R88A-CNEA02P-E	
Connectors for making I/O cables	M23 straight connector	R88A-CNEA01C-E	
	M23 right angle 90° connector	R88A-CNEA02C-E	
Blind plugs	For EtherCAT connectors	IP65 blind plug for M12 socket	R88A-PCVEA01-E
	For Power and I/O connectors	IP67 blind plug for M23 socket	R88A-PCVEA02-E

ALL DIMENSIONS SHOWN ARE IN MILLIMETERS.
 To convert millimeters into inches, multiply by 0.03937. To convert grams into ounces, multiply by 0.03527.